

**Z73W****Z74W****Z73P****Z74P**

1/2"-1 1/2" | DN15-DN40

CLASS 150/300

Floating Ball Flanged Up to **W** 260°C (500°F) | **P** 400°C (750°F)

## Valve dimensions

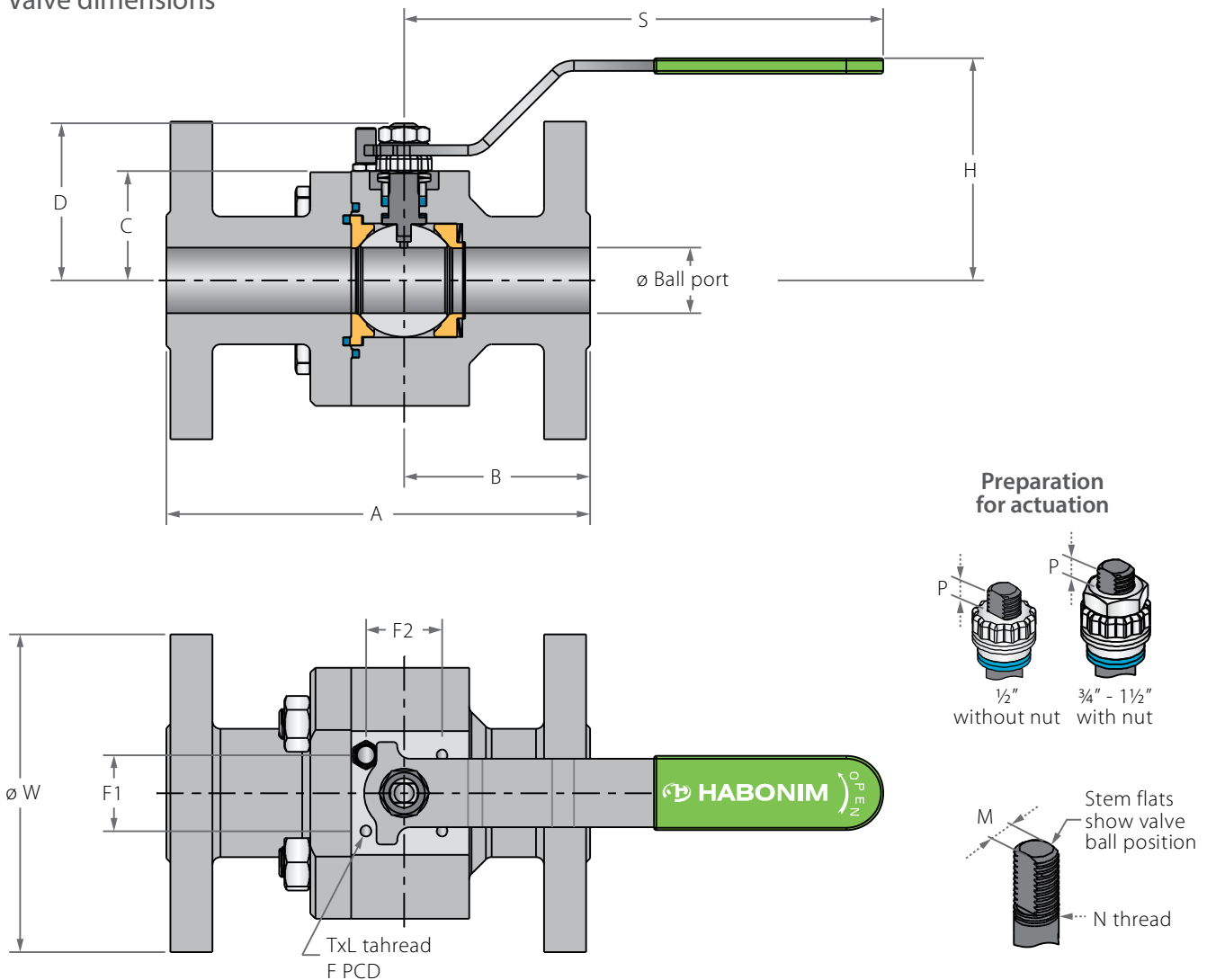

| Std. port | Unit | Ball port | A      |        | B     |       | C     | D     | H      | S      | W      |        | M    | N         | P          | F     | TxL   | Weight kg/lb |    | Kv Cv |
|-----------|------|-----------|--------|--------|-------|-------|-------|-------|--------|--------|--------|--------|------|-----------|------------|-------|-------|--------------|----|-------|
|           |      |           | 150    | 300    | 150   | 300   |       |       |        |        | 150    | 300    |      |           |            |       |       |              |    |       |
| DN15      | mm   | 14.30     | 108.00 | 139.70 | 49.00 | 60.00 | 29.40 | 40.40 | 92.00  | 151.00 | 89.00  | 95.00  | 5.54 | 1/2" UNF  | 6.65 (F03) | 36.00 | M5x10 | 2.70         | 4  | 28    |
| 1/2"      | inch | 0.56      | 4.25   | 5.50   | 1.93  | 2.36  | 1.16  | 1.59  | 3.62   | 5.94   | 3.50   | 3.74   | 0.22 | 1/2" UNF  | 0.26       | 1.42  | M5x10 | 6.00         | 9  | 32    |
| DN20      | mm   | 20.65     | 117.00 | 152.00 | 58.00 | 65.00 | 38.20 | 55.70 | 103.50 | 170.00 | 98.00  | 117.00 | 7.54 | 3/4" UNF  | 7.40 (F04) | 42.00 | M5x10 | 4.00         | 5  | 46    |
| 3/4"      | inch | 0.81      | 4.61   | 5.98   | 2.28  | 2.56  | 1.50  | 2.19  | 4.07   | 6.69   | 3.86   | 4.61   | 0.30 | 3/4" UNF  | 0.29       | 1.65  | M5x10 | 8.80         | 12 | 53    |
| DN25      | mm   | 25.50     | 127.00 | 165.00 | 55.00 | 73.00 | 42.65 | 60.20 | 108.00 | 170.00 | 108.00 | 124.00 | 7.54 | 7/16" UNF | 7.40 (F04) | 42.00 | M5x10 | 5.40         | 7  | 80    |
| 1"        | inch | 1.00      | 5.00   | 6.50   | 2.17  | 2.87  | 1.68  | 2.37  | 4.25   | 6.69   | 4.25   | 4.88   | 0.30 | 7/16" UNF | 0.29       | 1.65  | M5x10 | 11.90        | 15 | 93    |
| DN40      | mm   | 38.10     | 165.00 | 190.00 | 68.00 | 80.40 | 48.20 | 77.70 | 124.00 | 220.50 | 127.00 | 156.00 | 8.71 | 1/2" UNF  | 8.50 (F05) | 50.00 | M6x12 | 7.20         | 10 | 220   |
| 1 1/2"    | inch | 1.50      | 6.50   | 7.48   | 2.68  | 3.17  | 1.90  | 3.06  | 4.88   | 8.68   | 5.00   | 6.14   | 0.34 | 1/2" UNF  | 0.33       | 1.97  | M6x12 | 15.90        | 23 | 255   |

**Z73W****Z74W****Z73P****Z74P**1/2"-1 1/2" | DN15-DN40  
CLASS 150/300Floating Ball Flanged Up to **W** 260°C (500°F) | **P** 400°C (750°F)

## Components &amp; materials

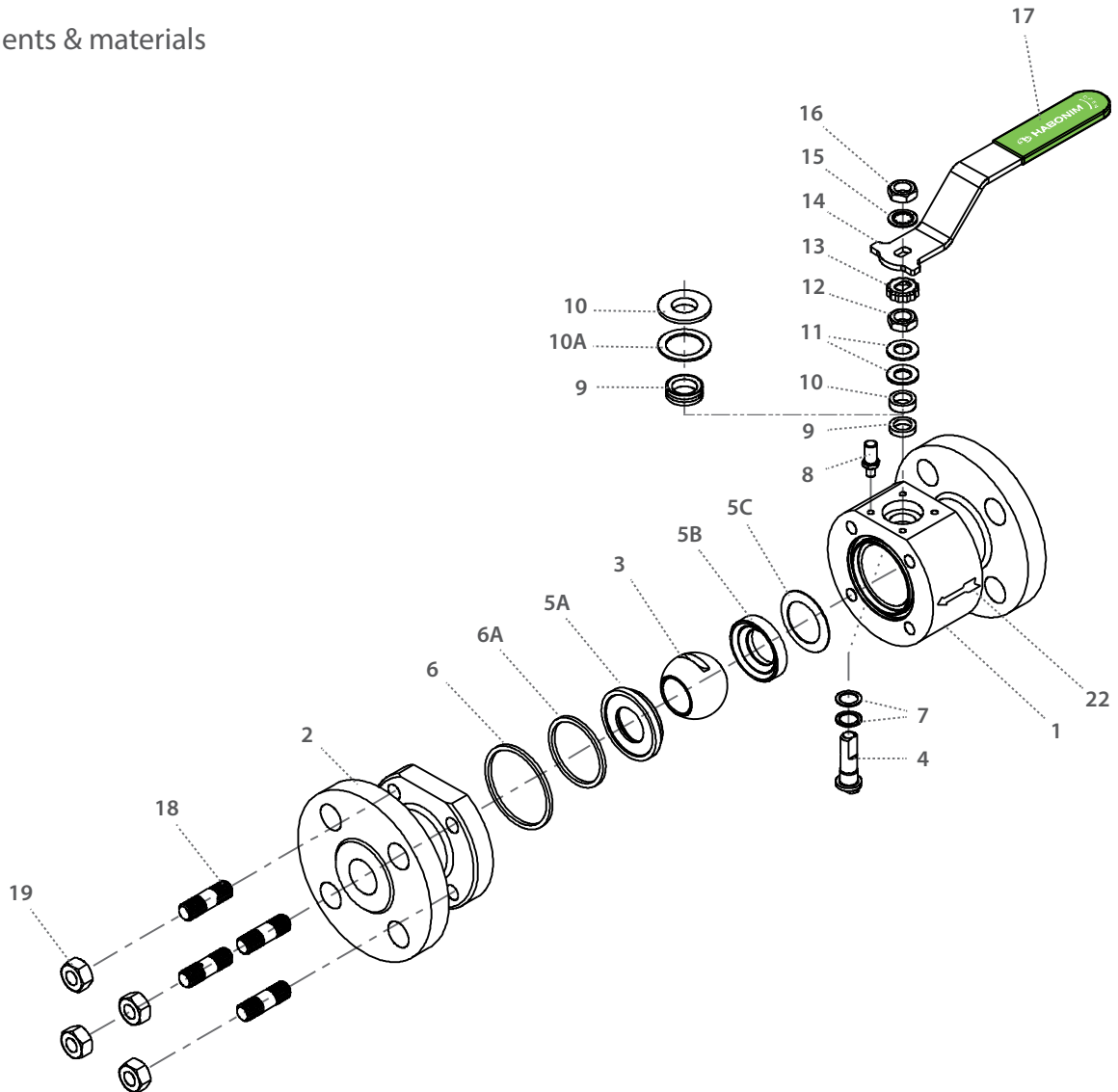

| Item | Description          | Material specification  | Qty. |
|------|----------------------|---|------|
| 1    | Body                 | Acc. Ordering Code  | 1    |
| 2    | End                  | Acc. Ordering Code  | 1    |
| 3    | Ball                 | Acc. Ordering Code  | 1    |
| 4    | Stem                 | Acc. Ordering Code  | 1    |
| 5A   | Upstream seat        | Acc. Ordering Code  | 1    |
| 5B   | Downstream seat      | Acc. Ordering Code  | 1    |
| 5C   | Upstream disc spring | Inconel 718   | 1    |
| 6*   | Body seal            | Graphite  | 1    |
| 6A*  | Seat seal            | Graphite  | 1    |
| 7*   | Stem thrust seal     | A479 316L Hardended with LTPN, B637 N07718 Inconel 718, Virgin peek,PCTFE | 2    |
| 8    | Stop pin             | S. Steel  | 1    |
| 9*   | Stem seal            | Graphite, CF PTFE, TFM  | 1    |
| 10   | Follower             | S. Steel  | 1    |

| Item | Description      | Material specification | Qty. |
|------|------------------|------------------------|------|
| 10A* | Slide Bearing    | S. Steel               | 1    |
| 11   | Disc spring      | S. Steel               | 2    |
| 12   | Stem nut         | S. Steel               | 1    |
| 13   | Locking clip     | S. Steel               | 1    |
| 14   | Handle           | S. Steel               | 1    |
| 15   | Serrated washer  | S. Steel               | 1    |
| 16   | Handle nut       | S. Steel               | 1    |
| 17   | Sleeve           | PVC                    | 1    |
| 18   | Body bolts/studs | S. Steel               | 4    |
| 19   | Body nuts        | S. Steel               | 4    |
| 22   | Arrow flow       | S. Steel               | 1    |
| 23   | Tag (not shown)  | S. Steel               | 1    |

\* Repair kit components

**Z73W****Z74W****Z73P****Z74P**

2"-8" | DN50-DN200

CLASS 150/300

Floating Ball Flanged Up to **W** 260°C (500°F) | **P** 400°C (750°F)

## Valve dimensions

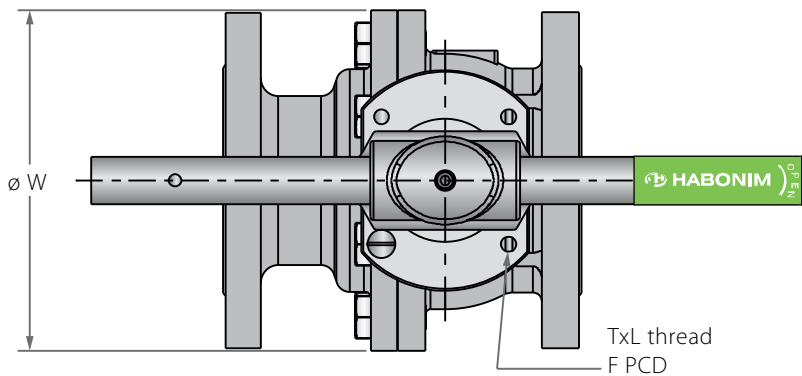
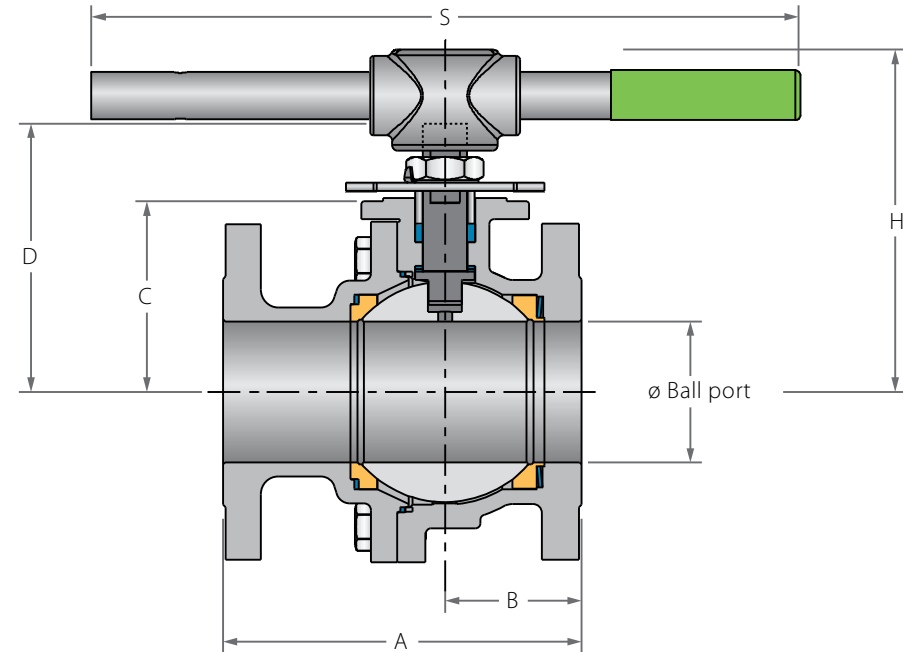

## Preparation for actuation

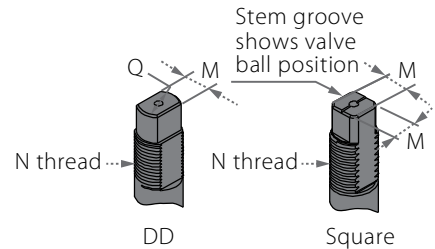
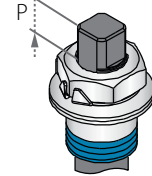

| Std. port | Unit | Ball port | A      |        | B      |        | C      | D      | H      | S      | W      |        | M     | M (DD) | Q     | N       | P           | F      | TxL    | Weight kg/lb |     | Kv Cv |
|-----------|------|-----------|--------|--------|--------|--------|--------|--------|--------|--------|--------|--------|-------|--------|-------|---------|-------------|--------|--------|--------------|-----|-------|
|           |      |           | 150    | 300    | 150    | 300    |        |        |        |        | 150    | 300    |       |        |       |         |             |        |        | 150          | 300 |       |
| DN50      | mm   | 50.05     | 178.00 | 216.00 | 69.00  | 75.10  | 70.00  | 111.60 | 137.30 | 256.00 | 152.00 | 165.00 | -     | 13.90  | 20.00 | M20x2.5 | 14.60 (F07) | 70.00  | M8X12  | 11           | 14  | 430   |
| 2"        | inch | 1.97      | 7.01   | 8.50   | 2.72   | 2.96   | 2.76   | 4.39   | 5.41   | 10.08  | 5.98   | 6.50   | -     | 0.55   | 0.79  |         | 0.57        | 2.76   |        | 25           | 31  | 499   |
| DN80      | mm   | 80.00     | 203.00 | 282.50 | 77.50  | 96.40  | 108.00 | 154.60 | 194.80 | 610.00 | 191.00 | 210.00 | 18.90 | 15.90  | 22.70 | 1"-14   | 16.70 (F10) | 102.00 | M10X20 | 22           | 28  | 1000  |
| 3"        | inch | 3.15      | 7.99   | 11.12  | 3.05   | 3.80   | 4.25   | 6.09   | 7.67   | 24.00  | 7.52   | 8.27   | 0.74  | 0.63   | 0.89  | UNF-2A  | 0.66        | 4.02   |        | 48           | 62  | 1160  |
| DN100     | mm   | 100.00    | 228.50 | 304.80 | 84.50  | 104.50 | 124.00 | 210.80 | -      | -      | 230.00 | 254.00 | 18.90 | 15.90  | 22.70 | 1"-14   | 16.70 (F10) | 102.00 | M12X20 | 39           | 44  | 1830  |
| 4"        | inch | 3.94      | 9.00   | 12.00  | 3.33   | 4.11   | 4.88   | 8.30   | -      | -      | 9.06   | 10.00  | 0.74  | 0.63   | 0.89  | UNF-2A  | 0.66        | 4.02   |        | 86           | 98  | 2123  |
| DN150     | mm   | 150.00    | 394.00 | 403.50 | 163.50 | 174.50 | 179.00 | 248.50 | -      | -      | 328.00 | 328.00 | 28.45 | 23.75  | 35.20 | 1½"-12  | 26.20 (F12) | 125.00 | M12x20 | 82           | 100 | 4380  |
| 6"        | inch | 5.91      | 15.51  | 15.89  | 6.44   | 6.87   | 7.05   | 9.78   | -      | -      | 12.91  | 12.91  | 1.12  | 0.94   | 1.39  | UNF-2A  | 1.03        | 4.92   |        | 181          | 220 | 5081  |
| DN200     | mm   | 200.00    | 457.20 | 501.80 | 242.50 | 240.70 | 241.00 | 353.70 | -      | -      | 450.00 | 450.00 | 35.92 | 35.92  | 46.50 | 2"-8    | 37.50 (F14) | 140.00 | M16X30 | 190          | 225 | 8070  |
| 8"        | inch | 7.87      | 18.00  | 19.75  | 9.55   | 9.48   | 9.49   | 13.93  | -      | -      | 17.72  | 17.72  | 1.41  | 1.41   | 1.83  | UN-2A   | 1.48        | 5.51   |        | 419          | 496 | 9361  |

**Z73W****Z74W****Z73P****Z74P**

2"-8" | DN50-DN200

CLASS 150/300

Floating Ball Flanged Up to **W** 260°C (500°F) | **P** 400°C (750°F)

## Components &amp; materials

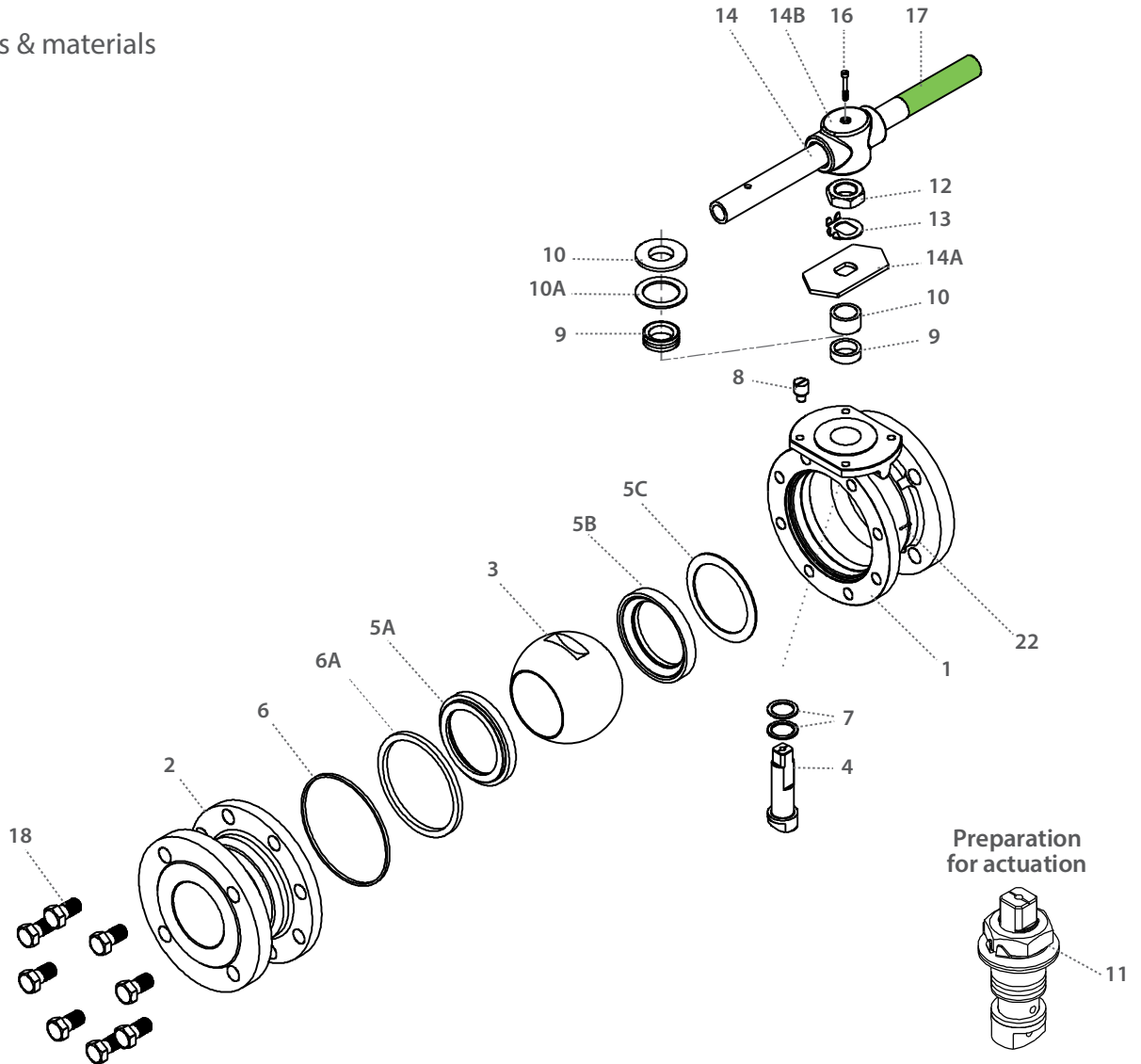

| Item | Description          | Material specification   | Qty. |
|------|----------------------|--|------|
| 1    | Body                 | Acc. Ordering Code   | 1    |
| 2    | End                  | Acc. Ordering Code   | 1    |
| 3    | Ball                 | Acc. Ordering Code   | 1    |
| 4    | Stem                 | Acc. Ordering Code   | 1    |
| 5A   | Downstream seat      | Acc. Ordering Code   | 1    |
| 5B   | Upstream seat        | Acc. Ordering Code   | 1    |
| 5C   | Upstream disc spring | Inconel 718  | 1    |
| 6*   | Body seal            | Graphite   | 1    |
| 6A*  | Seat seal            | Graphite   | 1    |
| 7*   | Stem thrust seal     | A479 316L Hardended with LTPN, B637 N07718 Inconel 718, Virgin peek, PCTFE | 2    |
| 8    | Stop pin             | S. Steel   | 1    |
| 9*   | Stem seal            | Graphite, CF PTFE, TFM   | 1    |
| 10   | Follower             | S. Steel   | 1    |

| Item | Description     | Material specification | Qty. |
|------|-----------------|------------------------|------|
| 10A* | Slide Bearing   | S. Steel               | 1    |
| 11   | Disc spring     | S. Steel               | 2    |
| 12   | Stem nut        | S. Steel               | 1    |
| 13   | Tab lock washer | S. Steel               | 1    |
| 14** | Handle          | S. Steel               | 1    |
| 14A  | Stop plate      | S. Steel               | 1    |
| 14B  | Wrench head     | S. Steel               | 1    |
| 16   | Wrench bolt     | S. Steel               | 1    |
| 17   | Sleeve          | PVC                    | 1    |
| 18   | Body bolts      | S. Steel               | 8-12 |
| 22   |                 | S. Steel               | 1    |
| 23   | Tag (not shown) | S. Steel               | 1    |

\* Repair kit components

\*\* Gear operator should be used for size 4" DN100 and above (handle components are not included)